

Camping

There is a full hook up campground in Okotoks and a camp ground in High River as well. I would recommend reservations for each. Call the town offices to obtain information.

On site There will be portable washrooms will be available. Please park in the marked spots

Directions

From Calgary – South on the #2 Highway exiting at the Okotoks overpass. Proceed south through the town of Okotoks to the intersection of #2A and #7 Highways. (There will be a Sobeys on your left at the intersection.) Turn right on to #7 highway. West on #7 highway past the Big Rock. Next left past Big Rock – 64th Street. South on 64th Street to 455 Avenue. Turn left (East) on 455 Avenue and watch for signs.

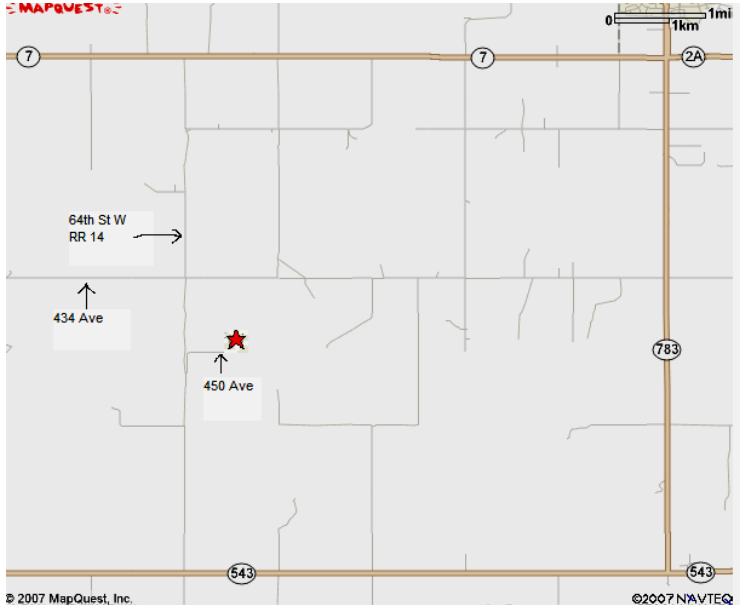
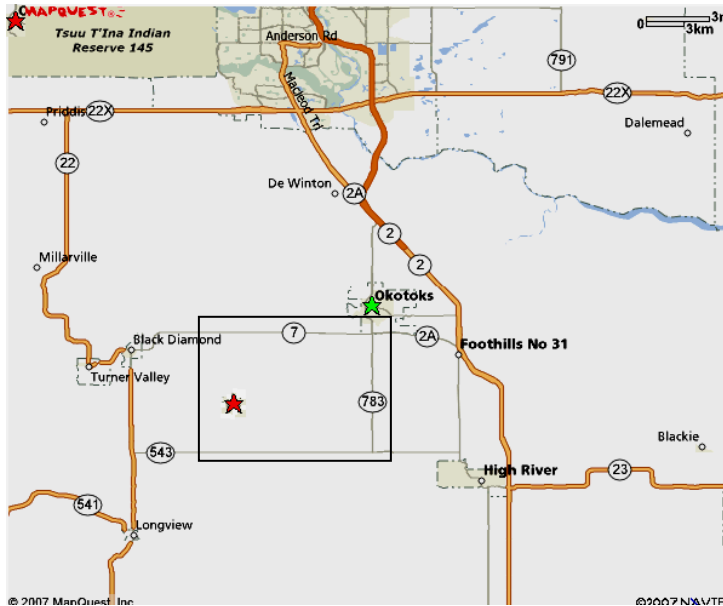

OFFICIAL PREMIUM LIST



Canadian Scottish Terrier Club First Earthdog Test Limited Entry

ENTRIES CLOSE 30 minutes before the scheduled start of class. Entries will close automatically when the following limits have been reached for the tests: 20 Introduction to Quarry, 25 Junior, 15 Senior, and 5 Master even if the official closing date and time for the entries has not arrived.

AUGUST 3rd, 2008 Outdoors: Rain or Shine CKC EARTHDOG TESTS

Introduction to Quarry
Junior Earthdog
Senior Earthdog
Master Earthdog

CKC APPROVED

These events are held under the rules of the Canadian Kennel Club
(unbenched) (unexamined)

THE CANADIAN SCOTTISH TERRIER CLUB

Officers of the club

President: Elizabeth McKellar
 Vice President: Karen Prokopetz
 Secretary: John Price
 Treasurer: Verna Moodie

TEST SECRETARY

To whom ALL entries must be sent
 Chris Wheeldon
 132 Copperstone Circle S.E.
 Calgary T2Z 0G6
 Mary Smithdorf 403-938-7631
 Email address: earthdog07@shaw.ca

Test Chairperson: Mary Smithdorf
Show Superintendent: Kyra Dennis
Earthdog Test Committee: Chris Wheeldon, Mel Miners
 Kathy McAra, Chris Duncan,
 Mary Smithdorf

CKC OFFICERS

Canadian Kennel Club - Joe Mauro, Acting CEO
 Canadian Kennel Club
 200 Ronson Drive, Suite # 400
 Etobicoke, Ont. M9W 5Z9

CKC Director: Anita Cairns
 RR5, Stn Lcd 1
 Calgary, AB T2P 2G6

TEST JUDGE
 Lia Bijsterveld
 10500 Dennis Cres
 Richmond, BC V7A 3R5

OFFICE USE	OFFICIAL CANADIAN KENNEL CLUB ENTRY FORM Canadian Scottish Terrier Club August 3rd 2008		OFFICE USE
I ENCLOSE \$ _____	ENTRY FEES \$ _____		
	LISTING FEES \$ _____		
PLEASE TYPE OR PRINT CLEARLY			
BREED _____		Variety: _____	__ MALE __ FEMALE
ENTER IN ONE OF THE FOLLOWING CLASSES:			
Test			Call Name: _____
IQ _____ ME _____			
JE _____			
SE _____			
REG. NAME OF DOG _____			
CHECK ONE AND ENTER NUMBER HERE		DATE OF BIRTH	
___ CKC REG. NO.	___ CKC ERN NO.	___ / ___ / ___	
___ CKC MISC. CERT. NO.	___ LISTED	Day Month Year	
NUMBER: _____		PLACE OF BIRTH	
		___ CANADA ___ ELSEWHERE	
BREEDER(S) _____			
SIRE _____			
DAM _____			
REG'D OWNER(S) _____			
OWNER'S ADDRESS _____			
CITY _____		PROV./STATE _____	POSTAL CODE _____
NAME OF OWNER'S AGENT (IF ANY) AT THE SHOW _____			
AGENT'S ADDRESS _____			
CITY _____		PROV./STATE _____	POSTAL CODE _____
MAIL ID TO: _____	___ OWNER	___ AGENT	
I CERTIFY that I am the registered owner(s) of the dog or that I am the authorized agent of the owner(s) whose name(s) I have entered above and accept full responsibility for all statements made in this entry. In consideration of the acceptance of this entry, I (we) agree to be bound by the rules and regulations of the Canadian Kennel Club and by any additional rules and regulations appearing in the premium list.			
SIGNATURE OF OWNER OR AGENT _____		TELEPHONE NUMBER _____	
E-MAIL ADDRESS: _____			

GENERAL INFORMATION AND TEST RULES

ELIGIBILITY: This test is open to all purebred Dachshunds and those CKC recognized Terriers in Group IV and the Miscellaneous Class list originally bred for or developed for use as earthdogs, small enough to fit into a 9 inch drain, as listed in Appendix A of the CKC Earthdog Test Rules & Regulations. Dogs must be aged 6 months or older.

ENTRY FEES: per dog per test if received prior to 9:00 PM, July 18th, 2008

Introduction to Quarry	\$15.00
Junior Earthdog	\$20.00
Senior Earthdog	\$20.00
Master Earthdog	\$20.00

Gate entries will be accepted up to 1/2 hour prior to the start of the following class unless the limit has been reached prior to that time.

For entries received after 9:00 PM, July 18th 2008 and Gate entry fees:

Introduction to Quarry	\$20.00
Junior Earthdog	\$25.00
Senior Earthdog	\$25.00
Master Earthdog	\$25.00

Mail entries to the Test Secretary. Make cheques payable to Canadian Scottish Terrier Club

Listing Fees: if non CKC Individually Reg's/ERN or PEN number \$8.40
Imported Miniature Dachshunds under one year of age
Listing fees..... \$2.10

ENTRIES: Entries must be complete, signed and submitted on the official CKC entry form. The order of competing shall be the order that entries are received.

ENTRIES CLOSE : ENTRIES CLOSE 30 minutes before the scheduled start of class.

Entries will close automatically when the following limits have been reached for the test: 20 Introduction to Quarry, 25 Junior, 15 Senior, and 5 Master even if the official closing date and time for the entries has not arrived.

BITCHES IN SEASON: Bitches in season shall not be eligible to enter the test. When a bitch comes into season after entry of the bitch has been submitted to the test secretary, a veterinarian's certificate, certifying that the bitch was in season within the 10 day period preceding the test must reach the secretary on or before the date of the test. The trial-giving club must refund the entry fee, service charge and listing fee. **CONFIRMATION OF ENTRY:** The receipt of entries will be confirmed for those providing a **return e-mail address** on their entry form.

QUARRY: The quarry used in these tests will be 2 adult gerbils

GENERAL INFORMATION AND TEST RULES

ATTENTION FOREIGN EXHIBITORS: Please note that fees are due and payable in Canadian dollars. Due to fluctuating currency rates, discounted cheques will not be accepted. Personal cheques will be accepted. If you pay by personal American cheque, it must be made out for the full amount of the entry and no exchange will be refunded to the exhibitor. Do not write "Payable in Canadian Funds" or "At Par". This will not be acceptable and will not be cleared by the bank. To simplify the process, we urge you to purchase bank drafts or money orders payable in Canadian funds.

Border Crossing: A valid rabies certificate is required to bring a dog into Canada. Government regulations require a certificate and it must be dated at least 30 days prior to entry into Canada. Canadian Food Inspection Agency regulations can be viewed at [:http://www.inspection.gc.ca/english/anim/heasan/import/dogse.shtml](http://www.inspection.gc.ca/english/anim/heasan/import/dogse.shtml).

Event Registration Number (Foreign Born/Foreign Owned Dog): For the purpose of entering CKC events to obtain CKC titles, individual registration is not required for foreign born, foreign owned dogs. Foreign exhibitors may apply for an ERN (Event Registration Number). This number MUST be applied for within 30 days of entering first CKC event to avoid cancellation. Exhibitors may submit a photocopy of dog's foreign Registration Certificate and the appropriate fee along with the completed application form. The form can be downloaded from <http://www.ckc.ca/forms> or is available by contacting the CKC Order Desk at 1.800.250.8040.

AWARDS: Qualifiers in Introduction to Quarry class, Junior, Senior and Master Classes will receive a Ribbon.

TEST PRECINCT: It will be the entire field north of the buildings. Dogs waiting to be tested shall be kept at least 30.5 m (100ft) from the perimeter of the test area in a designated holding area.

REGULATIONS: It is the responsibility of the exhibitor to be familiar with the rules pertaining to the event in which they are competing. Copies of the CKC Earthdog Test Regulations are available from the Canadian Kennel Club. Tel: (416) 675-5511.

CKC Regulation 15.7: It shall be the duty and obligation of the event giving club to see that a judge, club official, volunteer or any participant at an Earthdog test held under these regulations, is not subject to indignities. The Earthdog Test Committee Chair shall promptly report to the CKC any infringement of this regulation, and the Discipline Committee shall have the authority to take such action as it deems fit on receipt of a report indicating that this has occurred.

FOOD: There will be Beverages and Snacks available for sale at the trial... Please bring your own lunch.

TEST SITE: Bring water, shade and shelter for you and your dogs. These tests will be run **rain or shine**. The site is on a private acreage. All dogs must be under control, on a leash except during the test. Please pick up after your dogs.

OFFICE USE	OFFICIAL CANADIAN KENNEL CLUB ENTRY FORM Canadian Scottish Terrier Club August 3rd 2008		OFFICE USE
------------	---	--	------------

I ENCLOSE \$ _____	ENTRY FEES \$ _____
	LISTING FEES \$ _____

PLEASE TYPE OR PRINT CLEARLY

BREED _____ Variety: _____

___ MALE ___ FEMALE

ENTER IN ONE OF THE FOLLOWING CLASSES:

IQ _____ ME _____	Call Name: _____
JE _____	
SE _____	

REG. NAME OF DOG _____

CHECK ONE AND ENTER NUMBER HERE	DATE OF BIRTH
___ CKC REG. NO. ___ CKC MISC. CERT. NO.	___ CKC ERN NO. ___ LISTED
NUMBER: _____	Day / Month / Year PLACE OF BIRTH ___ CANADA ___ ELSEWHERE

BREEDER(S) _____

SIRE _____

DAM _____

REG'D OWNER(S) _____

OWNER'S ADDRESS _____

CITY	PROV./STATE	POSTAL CODE
------	-------------	-------------

NAME OF OWNER'S AGENT (IF ANY) AT THE SHOW _____

AGENT'S ADDRESS _____

CITY	PROV./STATE	POSTAL CODE
------	-------------	-------------

MAIL ID TO: ___ OWNER ___ AGENT

I CERTIFY that I am the registered owner(s) of the dog or that I am the authorized agent of the owner(s) whose name(s) I have entered above and accept full responsibility for all statements made in this entry. In consideration of the acceptance of this entry, I (we) agree to be bound by the rules and regulations of the Canadian Kennel Club and by any additional rules and regulations appearing in the premium list.

SIGNATURE OF OWNER OR AGENT _____ TELEPHONE NUMBER _____

E-MAIL ADDRESS: _____

OFFICE USE	OFFICIAL CANADIAN KENNEL CLUB ENTRY FORM Canadian Scottish Terrier Club August 3rd 2008		OFFICE USE
------------	---	--	------------

I ENCLOSE \$ _____	ENTRY FEES \$ _____
	LISTING FEES \$ _____

PLEASE TYPE OR PRINT CLEARLY

BREED _____ Variety: _____

___ MALE ___ FEMALE

ENTER IN ONE OF THE FOLLOWING CLASSES:

IQ _____ ME _____	Call Name: _____
JE _____	
SE _____	

REG. NAME OF DOG _____

CHECK ONE AND ENTER NUMBER HERE	DATE OF BIRTH
___ CKC REG. NO. ___ CKC MISC. CERT. NO.	___ CKC ERN NO. ___ LISTED
NUMBER: _____	Day / Month / Year PLACE OF BIRTH ___ CANADA ___ ELSEWHERE

BREEDER(S) _____

SIRE _____

DAM _____

REG'D OWNER(S) _____

OWNER'S ADDRESS _____

CITY	PROV./STATE	POSTAL CODE
------	-------------	-------------

NAME OF OWNER'S AGENT (IF ANY) AT THE SHOW _____

AGENT'S ADDRESS _____

CITY	PROV./STATE	POSTAL CODE
------	-------------	-------------

MAIL ID TO: ___ OWNER ___ AGENT

I CERTIFY that I am the registered owner(s) of the dog or that I am the authorized agent of the owner(s) whose name(s) I have entered above and accept full responsibility for all statements made in this entry. In consideration of the acceptance of this entry, I (we) agree to be bound by the rules and regulations of the Canadian Kennel Club and by any additional rules and regulations appearing in the premium list.

SIGNATURE OF OWNER OR AGENT _____ TELEPHONE NUMBER _____

E-MAIL ADDRESS: _____