



**JUDGING SCHEDULE – November 2 & 3, 2024**  
**Sat - 2 ALL BREED OBEDIENCE TRIALS (LIMITED ENTRY)**  
**Sun - 2 ALL BREED RALLY OBEDIENCE TRIALS (LIMITED ENTRY)**  
**JUNIOR HANDLING OBEDIENCE – SATURDAY Only**

**Interior Provincial Exhibition (IPE) Horticulture Building 3010 Wood Avenue, Armstrong BC**  
**OBEDIENCE/RALLY: INDOORS. Surface: Asphalt**  
**Held under the rules of the Canadian Kennel Club Unbenched and Unexamined**

**Judges: Gwen Roswell Kelowna BC – Obedience**  
**Karen Brearley Armstrong BC – Rally**  
**Sherry Correale Armstrong BC Junior Handling (Obedience)**

**Both Obedience Trials & Both Rally Trials are FULL**

**Day of Trial entries accepted subject to availability. These are limited entry trials.**  
**Each judge's assignment will not exceed more than 7 hours of judging time.**  
**Obedience & Rally ring size approximately 40' x 50' (2000 sq ft)**

**North Okanagan Tracking & Obedience Club Executive**

President: Erin Moore  
Secretary: Sherry Correale  
Vice President: Alice Jantzen  
Treasurer: Jayne Coneybeare  
Directors: Sandra Neill, Joy Viel

**Trial Officials**

Chairperson Erin Moore  
Secretary/Superintendent Margaret Zacher  
Trial Committee Erin Moore, Jayne Coneybeare, Alice Jantzen, Joy Viel

**Veterinarian:** Armstrong Veterinary Clinic,  
3125 Smith Dr, Armstrong, BC 250-546-9506

Crating is available in the building.

Please lock your vehicles and watch your belongings. Dogs and vehicles are left at your own risk. North Okanagan Tracking and Obedience Club will NOT accept responsibility for lost, stolen or damaged items.

**Obedience Scheduling is based on**

9 Pre-Novice,  
8 Novice,  
7 Open,  
6 Utility dogs per hour.

**Rally Scheduling is based on** 15 dogs per hour.

Please allow for absentees as this will affect the judging schedule. Judging will not begin prior to the hour scheduled

Please check in with the ring stewards on arrival.

Armbands available at Secretary Table.

**RENT A RING** Friday, Nov. 1 - 2 - 5 PM Limited Spaces - Book early to avoid disappointment  
Contact: Erin Moore [erinmoorebc@gmail.com](mailto:erinmoorebc@gmail.com)

**RV PARKING** Overnight RV camping will be available at the trial site with POWER HOOKUPS ONLY for \$30/night  
Contact: Jayne Coneybeare [jayneco@telus.net](mailto:jayneco@telus.net) All camping spots must be prepaid E-transfer to: [notoctreasurer@gmail.com](mailto:notoctreasurer@gmail.com)

**DINNER SATURDAY NIGHT** There will be a no host dinner at a local restaurant on Saturday night.  
Everyone invited! If you would like to join us, please contact Erin at [erinmoorebc@gmail.com](mailto:erinmoorebc@gmail.com)

**Obedience Trials – Saturday – November 2-2024**

Trial #1

**Ring 1  
Gwen Roswell**

**8:00 a.m.**

Obedience Utility B  
450, 353

Obedience Utility A  
401, 400

Obedience Open 18B  
355, 354, 353, 351, 350

Obedience Open 18A  
300

Obedience Novice Intermediate  
250

Obedience Novice B  
204, 203, 202, 201, 200

Obedience Novice A  
156, 155, 154, 152, 151, 150

Obedience Pre-Novice  
104, 103, 102, 100

---

**Ring 1  
Judging to start after the completion of Trial  
#1 – approx 11:15 a.m**

JR HANDLING OBEDIENCE

Trial #2

**Ring 1  
Gwen Roswell**

**Judging to start after the completion  
of JR Handling**

Obedience Utility B  
450, 353

Obedience Utility A  
401, 400

Obedience Open 18B  
355, 354, 353, 352, 351, 350

Obedience Open 18A  
300

Obedience Novice Intermediate  
250

Obedience Novice B  
204, 203, 201, 200

Obedience Novice A  
156, 102, 153, 152, 151, 150

Obedience Pre-Novice  
104, 103, 101, 100

**DAYLIGHT  
SAVING TIME ENDS**

**FALL BACK**

**Set Your Clocks Back an Hour**

Sunday, November 3,  
2024



**Rally Obedience Trials – Sunday – November 3-2024**

Trial #1

**Ring 1  
Karen Brearley**

**8:00 a.m.**

Rally Master  
952, 951, 950, 903

Rally Excellent B  
904, 804, 903, 902, 901, 900

Rally Excellent A  
850

Rally Advanced B  
805, 804, 803, 802, 801, 800

Rally Advanced A  
754, 753, 752, 703, 751, 750

Rally Intermediate  
710, 709, 708, 707, 706, 705, 704, 703, 701,  
700

Rally Novice B  
655, 654, 653, 652, 651, 650

Rally Novice A  
612, 611, 610, 609, 608, 606, 607, 605, 604,  
603, 602, 600, 601

Trial #2

**Ring 1  
Karen Brearley**

**Judging to start after the completion  
of Trial 1**

Rally Master  
952, 951, 950, 903

Rally Excellent B  
904, 903, 902, 901, 900

Rally Excellent A  
850

Rally Advanced B  
805, 803, 802, 801, 800

Rally Advanced A  
754, 705, 753, 752, 706, 702, 751

Rally Intermediate  
709, 708, 707, 704, 703, 702, 700, 701

Rally Novice B  
655, 654, 653, 652, 651, 650

Rally Novice A  
612, 611, 610, 609, 608, 606, 607, 603, 602,  
600, 601



*Fall Back!*

SUNDAY, NOVEMBER 3, 2024

**Change Your Clocks  
Back One Hour**

# ARMSTRONG SPALLUMCHEEN PARKS & RECREATION GROUNDS

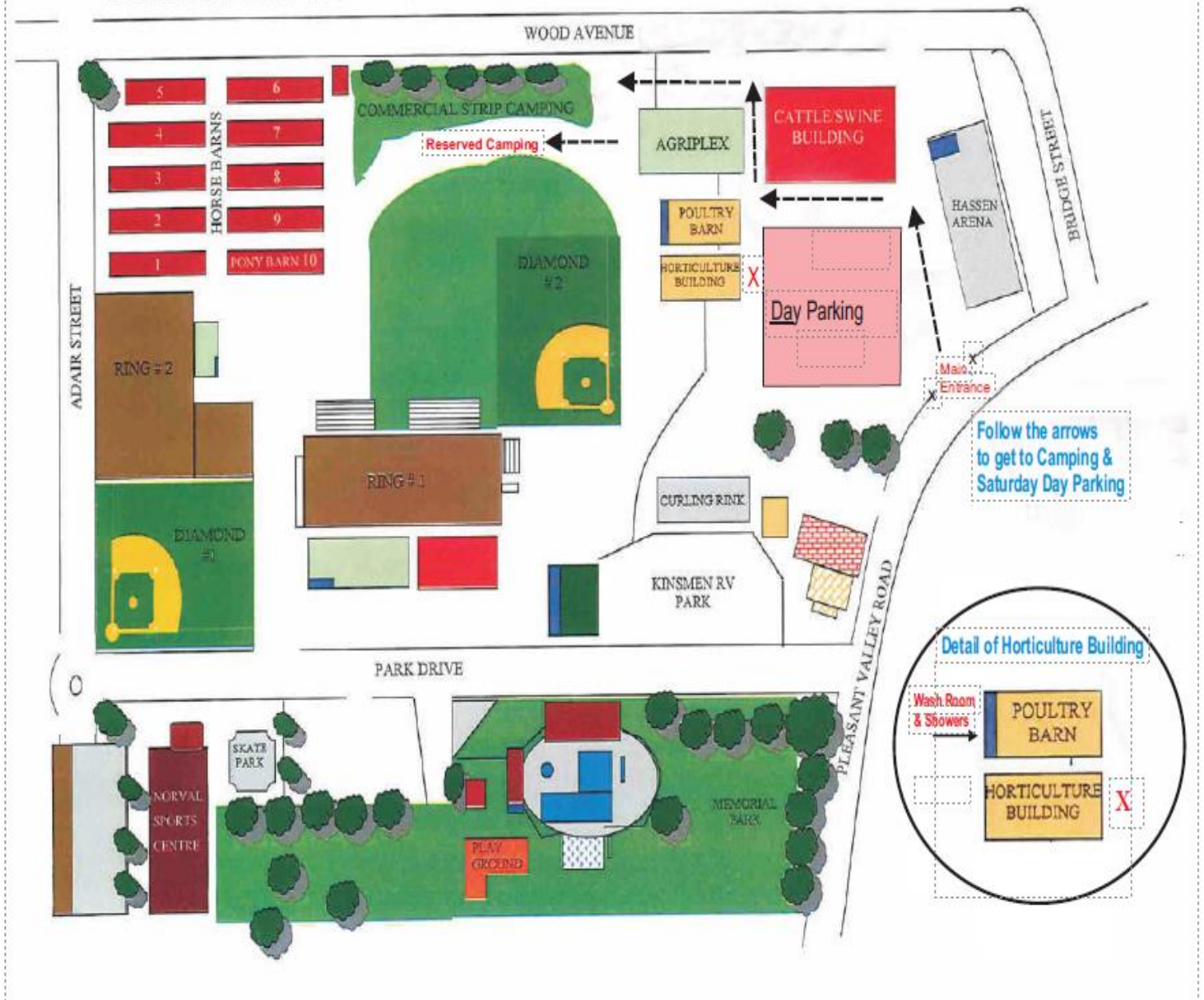

4.4.2 When the advertised limit (if applicable) has been reached, all remaining entries may be assigned a position (by class) on the reserve list. The person making the entry shall be notified of his position on the list. In the event that the entry of a bitch in season is withdrawn after the closing date, it may be substituted with one from the reserve list up to and including the day of the trial. At the club's discretion, if the club is notified in writing after the closing date that an entry other than a bitch in season will be absent from a trial, the entry may be substituted from the reserve list up to 24 hours prior to the trial. Fees will not be refunded for any reason other than a bitch being in season and to those on the reserve list who did not participate in the trial. Entry fees will be refunded within 10 days following the trial for those on the reserve list who did not participate in the trial.

**JUNIOR OBEDIENCE COMPETITION – Entries will be taken up to 10:30 am on Saturday.**