

Manage the crucial Birth period with

# Royal Canin

Birth  
& Growth  
program

Now available: Tailor-made nutrition for mothers and puppies



(1) Source: Royal Canin internal data - R&D study/Field validation on breeders and owners - 2009-2010  
(2) Source: Royal Canin internal data - Breeders' network - Field validation on 350 puppies - 2010  
(3) Source: Royal Canin internal data - Field validation on 161 puppies of private dog owners - 2010

More than 1.000 puppies have participated in the development of this new nutritional offer™

82%™ found the rehydrating quality of the new Starter to be excellent or good.

82%™ are fully satisfied or satisfied with Starter's digestive tolerance during the weaning phase.

90%™ are fully satisfied or satisfied with the new Junior formula on 4 essential criterias: palatability - hair&skin - body condition - digestibility.

Available for Mini, Medium, Maxi, Giant dogs.  
For more information please visit us at [www.royalcanin.ca](http://www.royalcanin.ca)

To contact the:  
**Elite Breeder's Club**  
[breedersclub@royalcanin.ca](mailto:breedersclub@royalcanin.ca)  
or 1-800-527-2673



OFFICIAL PREMIUM LIST



85<sup>th</sup>, 86<sup>th</sup> & 87<sup>th</sup> All Breed

## CHAMPIONSHIP DOG SHOWS

Friday, NOVEMBER 25, 2011  
Saturday, NOVEMBER 26, 2011  
Sunday, NOVEMBER 27, 2011



ORANGEVILLE AGRICULTURE BUILDING  
Orangeville Fairgrounds  
5th Side Road (1-1/2 miles N.E. of Orangeville)

These Shows Held Under Canadian Kennel Club Rules  
Unbenched – Indoors

### SPECIALTY SHOWS

CANADIAN YORKSHIRE TERRIER ASSOCIATION  
NORFOLK TERRIER CLUB OF CANADA  
GERMAN SHORTHAIRED POINTER CLUB OF CANADA  
CHINESE CRESTED CLUB OF ONTARIO

### 18 BOOSTER SHOWS

Barbets, German Shorthaired Pointers, Rhodesian Ridgebacks (2), Doberman Pinschers, Leonbergers (2), Samoyeds, Standard Schnauzers, Kerry Blues, Norfolk Terriers (2), Parson Russell Terriers, West Highland White Terriers, French Bulldogs, Lhasa Apsos (2) and Collies/Shetland Sheepdogs

CPHA TOP DOG DINNER – Friday Evening November 25, 2011



ROYAL CANIN BREEDERS CLASSIC – Saturday Evening November 26, 2011

### JUNIOR HANDLING

Saturday, November 26, 2011 & Sunday, November 27, 2011 with a Special Unofficial Junior Showmanship Invitational Run Off on Sunday, November 27, 2011

Breed Seminars – Nutrition Seminars – Reproduction Seminars – Junior Handling Classes  
Public Orientation Tours – Dog Cart Rides – Performance Demonstrations  
Go to [www.caledondogs.com](http://www.caledondogs.com) to see the dates and times for these events

ENTRIES CLOSE 8:00 P.M. (EST) WEDNESDAY, NOVEMBER 9, 2011

To comply with instructions issued by the Canadian Kennel Club we will be unable to accept any entry reaching our Show Secretary after that date and time.

**CALEDON  
KENNEL  
ASSOCIATION  
OFFICERS**

<i>President</i>	Judi Orsi	<i>Directors</i>
<i>Vice President</i>	Carol Stubbs	Alan Ewles
<i>Treasurer</i>	Rosemary Shoreman	Michael Shoreman
<i>Secretary</i>	Kim Birch	Walter Hurtick

**SHOW & TRIAL  
COMMITTEE**

<i>Show Chair</i> Rosemary Shoreman (705) 322-7853	<i>Booth Chair</i> Kim Birch
<i>Show Superintendent &amp; Secretary</i> MJN Show Services 9 Samya Court www.mjnshowservices.com Scarborough, ON M1R 2A4 (416) 759-8593	<i>Trophy Chair</i> Anne Swantee
<i>Show Photographer</i> Dean Dennis Photography P.O.Box 123, Arden, ON K0H 1B0 (613) 335-4386 dean@deandennisphotography.com	<i>Breed Education Chair</i> Alan Ewles
<i>Chief Ring Steward</i> Norma Egginton	<i>Public Relations Chair</i> Dannielle Adams
<i>Show Veterinarian – On Call</i> Graham Animal Hospital 98 Main Street, Hillsburgh, ON N0B 1Z0 (519) 855-6439	<i>Public Information Chair</i> Naomi Kane
	<i>Meet The Breeds Chair</i> Joyce Billingham
	<i>Junior Handling Chair</i> Carol Stubbs
	<i>Judges Hospitality</i> Judith Orsi
	<i>Specialties &amp; Booster Chair</i> Michael Shoreman

**JUDGES**

**Robert Black**  
1593 Mud Road, Wrightstown, PA 18940-9636 U.S.A.

**Myrtle Elms**  
149 Saint Lucie Drive, Weston, ON, M9M 1T4

**Carlos Quinones**  
Calle 123 No.60-23, Bogata, Colombia

**Stefan Sinko**  
Glavna ul.47, Lendava, Slovenia 9220

**Dr. Robert Smith**  
P.O.Box 309, St. Stephans Church, VA 23148-0309, U.S.A.

**Mrs. Robert (Polly) Smith**  
P.O.Box 309, St. Stephans Church, VA 23148-0309, U.S.A.

**Robert Wilson**  
20 Forest Hill Drive, R.R.#3, Everett, ON L0M 1J0

**Janice Wolff**  
98 Greenfield Rd, Brantford, ON N3R 6Z7

**MOTELS and  
CAMPING**

The following motels that allow dogs state that owner/handlers will be held responsible for any and all damage. Dogs must not be groomed or bathed in the motel rooms. Owners must clean up after exercising their dogs on motel property.

**HOST HOTEL**

**Hockley Valley Resort**

R.R. 1, Orangeville ON L9W 2Y8

(416) 363-5490

Special Event #244958

Single \$155.00; Double \$169.00 (includes full breakfast)

Must be booked by October 16, 2011

www.hockley.com (no dogs)

**Days Inn Brampton**

260 Queen Street East, Brampton ON L6V 1B9

(905) 457-8880 (Plus \$10.00 pet fee)

**Best Western Orangeville**

7 Buena Vista Drive, Orangeville, ON L9W 0A2

(519) 941-3311 (Does not allow dogs)

**MillCroft Inn**

55 John Street, Alton, ON L7K 0C4

(519) 941-8111 Toll Free: 1-800-383-3976

(allows dogs under 30 lbs. for \$35.00 per night, per room)

Camping for trailers is \$40.00 for the weekend, including hydro.  
Contact Scott, Manager, Orangeville Fairgrounds  
(519) 942-9597 or e-mail: manager@orangevillefairgrounds.ca.

**MAP**

**Directions to Orangeville Fairgrounds**

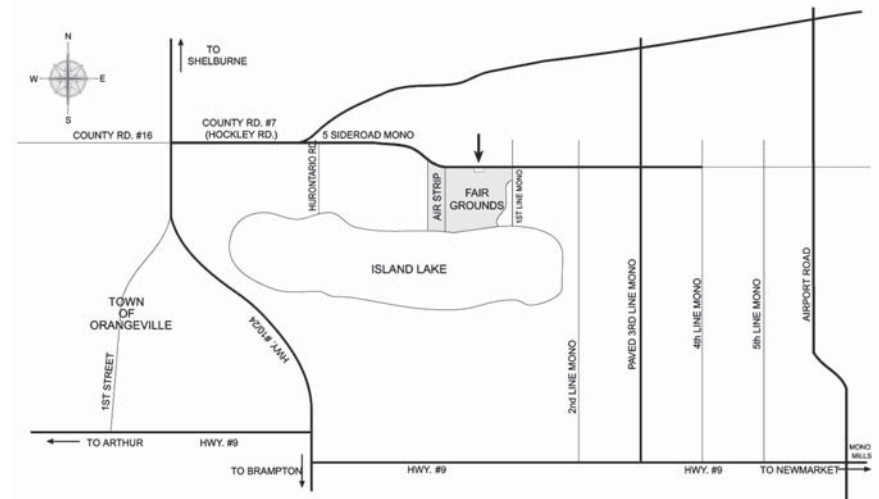

**CHAMPIONS AND CHAMPIONSHIP POINTS**

Chapter 15, Section 15.1.1 A dog awarded Winners at a conformation show shall be credited with a number of championship points (ranging from 0 to 5) and the number of championship points credited to a dog awarded Winners shall be as provided hereunder.

Section 15.1.2 The schedule to be employed in the determination of the number of points to be allocated a dog awarded WINNERS shall be as follows:

Dogs competing*	1	2	3 to 5	6 to 9	10 to 12	13 or more
Points allocated	0	1	2	3	4	5

\*includes the dog awarded Winners.

In counting the number of eligible dogs in competition, a dog that is disqualified, dismissed, excused or ordered from the ring by the judge SHALL be included in the calculation for championship points.

To determine the number of championship points earned by a dog awarded Winners, total all the dogs in competition which the dog defeated, directly or indirectly, for the highest of the following official breed awards: Winners, Best of Winners, Best of Breed, or Best of Opposite Sex and then consult the schedule set forth above.

Section 15.1.8 A Dog awarded Winners which also places in the regular Group competition shall be credited with the following additional points, provided that a dog was defeated at the group level, save that no more than five (5) points will be credited to a dog for a single show.

Number of Breeds Competing at Group Level	Dog Placed First	Dog Placed Second	Dog Placed Third	Dog Placed Fourth
13 or more	5	4	3	2
10 to 12	4	3	2	1
6 to 9	3	2	1	1
5	2	1	1	1
4	2	1	1	0
3	2	1	0	0
2	1	0	0	0
1	0	0	0	0

Section 15.1.11 A class dog awarded Best in Show at an all-breed Championship show will be credited with five points inclusive of any points earned at the breed or group level.

Section 15.1.12. In order for a dog to be recognized as a Champion and its owner provided with a Championship Certificate, the dog must have earned at least one 2 point win either at the breed or group level.

**MOVING CLASS DOGS TO SPECIALS**

Chapter 8, Section 8.9 of the Conformation Show Rules and Regulations has been amended to allow a dog which is individually registered in the records of the Canadian Kennel Club, and has completed the requirements for a Championship, after the Closing Date for entries for a show, may be transferred from one of the Regular Classes to "Specials Only", providing the request for a transfer is submitted to the Show Secretary in WRITING at least one hour prior to the opening of the show, by the owner or handler. Every day of a 2 or 3 day show is a separate show. Please note that this rule is effective up to one hour prior to the opening of the show, NOT one hour prior to the judging of the breed.

**CONFORMATION SHOW RULES AND REGULATIONS**

The Exhibitor is responsible for knowing and complying with the Conformation Show Rules and Regulations of the Canadian Kennel Club. Chapter 4 - Section 4.7.3 of the Conformation Show Rules and Regulations states: A judge officiating at a show held under these rules shall not be subjected to indignities of any kind during the progress of the show. It shall be the duty and obligation of the club holding the show to see that this rule is effectively carried out.

**JUDGES ASSIGNMENTS**

**FRIDAY, NOVEMBER 25, 2011**

- Mrs. R (Polly) Smith** All breeds in Group 1 and Group 1 at group level  
All breeds in Group 4 and Group 4 at group level
- Mr. C. Quinones** All breeds in Group 2 and Group 2 at group level  
All breeds in Group 6 and Group 6 at group level
- Dr. R. Smith** All breeds in Group 3 and Group 3 at group level
- Mr. S. Sinko** All breeds in Group 5 and Group 5 at group level  
All breeds in Group 7 and Group 7 at group level  
Best in Show, Best Puppy in Show

**SATURDAY, NOVEMBER 26, 2011**

- Dr. R. Smith** Braque francais to and including German Longhaired Pointer, German Wirehaired Pointer to and including Weimaraner and Group 1 at group level  
All breeds in Group 6 and Group 6 at group level
- Mrs. R (Polly) Smith** All breeds in Group 2 and Group 2 at group level  
All breeds in Group 5 and Group 5 at group level  
Best in Show, Best Puppy in Show
- Mr. S. Sinko** Barbet and German Shorthaired Pointer  
All breeds in Group 3 and Group 3 at group level
- Mr. R. Black** All breeds in Group 4 and Group 4 at group level
- Mr. C. Quinones** All breeds in Group 7 and Group 7 at group level

**SUNDAY, NOVEMBER 27, 2011**

- Mr. C. Quinones** All breeds in Group 1 and Group 1 at group level  
Affenpinschers to and including Toy Xoloitzcuintli and Group 5 at group level  
Best in Show, Best Puppy in Show
- Dr. R. Smith** All breeds in Group 2 and Group 2 at group level  
Norfolk Terrier, Yorkshire Terrier  
All breeds in Group 7 and Group 7 at group level
- Mrs. R (Polly) Smith** All breeds in Group 3 and Group 3 at group level
- Mr. S. Sinko** Airedale Terrier to and including Manchester Terrier, Norwich Terriers to and including West Highland White Terrier and Group 4 at group level  
All Breeds in Group 6 and Group 6 at group level

**ENTRY FEES CHAMPIONSHIP SHOW**

Entry fee per dog, per show .....	<b>\$30.00</b>
Listing Fee per dog, per show .....	<b>\$9.38</b>
Exhibition Only .....	<b>\$10.00</b>
Prepaid Catalogue .....	<b>\$8.00</b>
Catalogue at show .....	<b>\$10.00</b>

**All fees include H.S.T. and are in Canadian Funds.** A listing fee is payable for all dogs entered at shows who do not have an individual C.K.C. registration number, or an E.R.N. Listing fee does not apply to sweepstakes, non-regular or unofficial classes. All cheques and money orders are to be made payable to **Caledon Kennel Association** and mailed to:

MJN Show Services  
9 Samya Court  
Scarborough, ON M1R 2A4

**Entries close 8:00 p.m. (EST) Wednesday, November 9, 2011**

**FAX/CREDIT CARD ENTRIES- MJN SHOW SERVICES**

**MJN Show Services – Fax Number: 416-759-7790**  
 MJN Show Services will accept entries when paid by VISA, Mastercard or American Express. Charge is \$3.00 per dog per show for this service. Declined credit cards will be deemed non-payment and entries will be returned. Entries processed by credit card and then cancelled before closing time will be charged a fee of \$3.00. *MJN Show Services will not be held responsible for any difficulties encountered with fax transmissions. Please call to confirm receipt prior to closing.*

**THE ENTRY LINE**



**THE ENTRY LINE – www.theentryline.com**  
 (519) 754-0393 1-800-293-2935 Fax: (519) 754-0796  
 Mastercard/Visa/American Express.

The Entry Line will close off their telephone and fax lines 2 hours before closing at 6:00 p.m. EST on Wednesday, November 9, 2011. This is a privately owned business that charges a fee for their service. MJN Show Services is not responsible for any errors made through The Entry Line.

**USA EXHIBITORS**

Bank drafts or money orders in Canadian Funds and personal cheques, payable in U.S. funds, and for the full amount of the entry will be accepted. Personally discounted cheques will not be honoured. Please do not mark personal cheques "Payable in Canadian Funds" or "At Par" as such items are not cleared through the banks. Your cooperation is appreciated.

**CATALOGUES**

Catalogues are available on a PRE-ORDER basis. Those who wish to pre-order at a price of \$8.00 may do so by indicating this on their entry form. Your catalogue will be waiting for you at the show. There will be a limited number of catalogues available for sale at the show for a price of \$10.00.

**CKC INFORMATION**

The Canadian Kennel Club – Mrs. Leila Bahorie, Acting C.E.O.  
 200 Ronson Drive, Suite 400  
 Etobicoke ON M9W 5Z9  
 Telephone (416) 675-5511 Fax: (416) 675-6506  
 Hours: 9:00 am - 5:00 pm Monday - Friday

**CKC Director**  
 Mr. Richard Paquette (800) 836-6661  
 Box 640, 411 St. Agnes St. W. (705) 983-5147 (fax)  
 Azilda ON P0M 1B0 wenrick@wenrick.ca

**Conformation Representative – Jo Ann Pavay**

**GROUP JUDGING**

will start after all individual breeds have been judged in the Special Events Ring. Puppy groups will be judged in Ring 1.

**JUNIOR HANDLING JUDGING**

Top Overall Junior Handler of the day will be judged before BIS on Saturday & Top Overall Junior Handler over the two days will be judged before BIS on Sunday.



OFFICIAL CANADIAN KENNEL CLUB FORM  
**CONFORMATION**  
**CALEDON KENNEL ASSOCIATION**

- Friday, November 25, 2011
- Saturday, November 26, 2011
- Sunday, November 27, 2011

Entry Fees (\$30.00 per show) \$ \_\_\_\_\_  
 Listing Fees (\$9.38 per show) \$ \_\_\_\_\_  
 Exhibition Only (\$10.00 per show) \$ \_\_\_\_\_  
 CATALOGUE (\$8.00 each) \$ \_\_\_\_\_  
 TOTAL enclosed \$ \_\_\_\_\_

**CLOSING DATE: 8 p.m. EST**  
**WED. NOVEMBER 9, 2011**

Make fees payable to  
**Caledon Kennel Association** and mail to:  
 MJN Show Services  
 9 Samya Court  
 Scarborough, ON M1R 2A4

*Please type or print clearly*

Breed	Variety	Sex
-------	---------	-----

Enter in the following Classes:

- Junior Puppy
- Senior Puppy
- 12 - 18 Month
- Canadian Bred
- Bred by Exhibitor
- Open
- Specials Only
- Exhibition Only

Reg. Name of Dog \_\_\_\_\_

Check One – and – Enter Number here  <input type="checkbox"/> CKC Reg. No. <input type="checkbox"/> CKC ERN No. <input type="checkbox"/> CKC Misc. Cert. No. <input type="checkbox"/> Listed	Date of Birth D ____ M ____ Y ____	Is this a puppy? YES ___ NO ___
---	---------------------------------------	------------------------------------

Place of Birth <input type="checkbox"/> Canada <input type="checkbox"/> Elsewhere
--

Breeder(s) \_\_\_\_\_

Sire \_\_\_\_\_

Dam \_\_\_\_\_

Reg'd Owner(s) \_\_\_\_\_

Owner's Address \_\_\_\_\_

City	Prov.	Code
------	-------	------

Name of Owner's Agent (if any) at the Show \_\_\_\_\_  
 Agent's Address \_\_\_\_\_

City	Prov.	Code
------	-------	------

Mail I.D. to  Owner or  Agent Email \_\_\_\_\_

**FAX/CREDIT CARD ENTRIES**

Amer Express  Mastercard  VISA Card No. \_\_\_\_\_ Expiry \_\_\_\_\_  
 Name of Cardholder \_\_\_\_\_ Signature \_\_\_\_\_

I CERTIFY that I am the registered owner(s) of the dog or that I am the authorized agent of the owner(s) whose name(s) I have entered above and accept full responsibility for all statements made in this entry. In consideration of the acceptance of this entry I (we) agree to be bound by the rules and regulations of the Canadian Kennel Club and by any additional rules and regulations appearing in the premium list. Also by signing this form, I certify that I will not hold the Show giving Club, its members, directors, employees or agents liable in the event of any accident of misfortune however caused.

SIGNATURE OF OWNER OR AGENT

TELEPHONE NO.



## SPECIALTY CONFORMATION CLASSES – BOTH SEXES

### OFFICIAL CLASSES:

**JUNIOR PUPPY** – a dog between 6 mos. & under 9 mos. on day of show.

**SENIOR PUPPY** – a dog between 9 mos. & under 12 mos. on day of show.

**12-18 MONTHS** – a dog between 12 mos. & under 18 mos. on day of show.

**CANADIAN BRED** – a dog which is born in Canada.

**BRED BY EXHIBITOR** – dogs owned and handled in the ring by the breeder. The handler must be the owner/co-owner AND breeder/co-breeder of the dog. The owner/breeder must handle the dog in this class, but need not handle the dog for further awards.

**OPEN CLASS** – for all dogs.

**VETERANS CLASS** – for all dogs over seven years of age as of the date of the show. These dogs to compete for the regular placements, and the 1st place Dog and Bitch will go on to compete for Best of Breed. The winner of the Veterans Class will not compete for points but go directly into the Best of Breed competition. Dogs entered in this class may be spayed or neutered.

**SPECIALS ONLY** – dogs who are Canadian Champions only.

**AWARD OF MERIT** – at the judge's discretion, Awards of Merit may be awarded up to one Award for every ten dogs competing for Best of Breed, which will be presented following Best of Breed.

### UNOFFICIAL CLASSES:

**FIELD DOG & FIELD BITCH** – Shall be for all dogs who have earned a Qualifying score at a Licensed CKC Field Dog Test (Canada) or at a Licensed AKC Hunting Test (USA), or have received a placement at a Licensed CKC Field Trial (Canada) or at a Licensed AKC Field Trial (USA) prior to the closing of entries. Dogs must be at least 6 months of age or older and eligible for registration. Each entrant for Field Dog or Field Bitch Class must be entered in one of the Official Classes in the specialty or exhibition only. This class is divided by sex. (German Shorthaired Pointer Club specialty)

### NON-REGULAR CLASSES:

**EXHIBITION ONLY** – all dogs entered in this class shall be listed in the catalogue with the same particulars as dogs entered in regular competition. Dogs entered in this class may not compete in any Regular class but may enter and compete in Non-Regular classes and/or Parades.

**STUD DOG & GET** – Stud Dog and two or more of his get. Stud must be entered in a Regular class or Exhibition Only. Get must be entered in a Regular class. Stud Dog may be neutered. Ownership in this class need not be identical.

**BROOD BITCH & PROGENY** – Brood Bitch and two or more of her progeny. Brood Bitch must be entered in a Regular class or Exhibition Only. Progeny must be entered in a Regular class. Brood Bitch may be spayed. Ownership in this class need not be identical.

**BREEDER/OWNER/HANDLER** – open to all dogs owned and handled by the breeder during all regular class judging. The handler must be the owner/co-owner and breeder/co-breeder of the dog. All eligible dogs not directly or indirectly defeated by another eligible dog will compete for this award. The breeder/owner must handle the dog in its regular class, but in the case of having multiple eligible dogs, need not handle the dog for this competition. (Chinese Crested Club specialty)

*All dogs entered in these Non-Regular Classes must be entered in one of the Regular CKC Classes, for "Specials Only" or for "Exhibition Only".*

---

## ENTRY INFORMATION

1. No entry will be accepted unless all particulars called for on the entry form are completed in full. Handlers or agents please note the full name and address of all owners must be filled in.
2. Incomplete entries will be returned. No entry will be accepted unless accompanied by entry fees. Telephone and telegraph entries cannot be accepted. Exhibitors must abide by errors made in entering their dogs regardless of how or by whom the entries were made.
3. There is no refund for duplicate cheques. Every effort will be made to find all duplicate entries, however if the entry has been processed and appears in the official catalogue, no refund will be made.
4. Substitutions or cancellations of any entry after the closing date is prohibited. Moving Class Dogs to Specials is permitted. An error in the class, date of birth or sex may be amended on the entry form up to one hour before the start of the show. Only dogs which are already registered in the Canadian Kennel Club Stud Book, or are eligible for such registration can be entered. The committee reserves the right to refuse any entry subject to CKC Rules. **Entries positively close 8:00 p.m. (EST) WEDNESDAY, NOVEMBER 9, 2011** and must be in the hands of the Show Secretary by that date.
5. Identification cards and judging schedules will be mailed as soon as possible after the entries close. Identification cards must be presented upon arrival at the show.
6. Tendering of NSF cheques in payment of fees shall be considered non-payment of fees and is punishable by disciplinary action. **Any N.S.F. cheques will be subject to a \$20.00 service charge.**

---

## GENERAL INFORMATION

1. The Show Superintendent will be in full charge of the show which will be governed by CKC Rules.
2. The Caledon Kennel Association will use due care and diligence for the welfare of dogs and exhibitors, but will not be responsible for, or assume liability in the event of accident, or other misfortunes, to either dogs, exhibitors or patrons.
3. If, because of riot, civil disturbance or other acts beyond the control of management, it is impossible to open or to complete the show, no refund of Entry will be made.
4. Dogs should arrive in adequate time for their breed judging (allowing for absences) and will be excused each show when not required for further judging. It is the responsibility of the exhibitors to have the dog at ringside when the dog's class is scheduled for judging. Waiting for dogs will not be possible and handlers with several breeds must arrange for alternate handlers if judging times for their breeds conflict.
5. Judging will commence at 8 a.m. each day. A later starting time may be specified in the judging schedule. Starting time of each ring will be specified in judging schedule.
6. Extra security in the building will be provided on Friday between 4 pm and midnight to accommodate exhibitors attending the Top Dog Dinner. All other nights the building will be locked at 10 pm and re-opened for 6:30 am.
7. The Show precincts shall consist of all areas set out for rings, and the facilities set aside for show officials, judges or exhibitors and handlers.
8. **GROOMING AREA** – Space will be at a premium in the grooming area. A heated, enclosed x-pen area is provided off the grooming area. No x-pens will be allowed on the floor at any time. We ask that all exhibitors be mindful of keeping their area confined by stacking crates and keeping chairs and equipment to a minimum.
9. An **IN TRANSIT AREA** will be available for owners/handlers who are transporting dogs not entered in the show. All dogs issued an In Transit Pass, must be 6 months of age or older. The owner/agent is responsible for the care of said dog.



OFFICIAL CANADIAN KENNEL CLUB FORM  
**CONFORMATION**  
**CALEDON KENNEL ASSOCIATION**

- Friday, November 25, 2011  
 Saturday, November 26, 2011  
 Sunday, November 27, 2011

Entry Fees (\$30.00 per show) \$ \_\_\_\_\_  
 Listing Fees (\$9.38 per show) \$ \_\_\_\_\_  
 Exhibition Only (\$10.00 per show) \$ \_\_\_\_\_  
 CATALOGUE (\$8.00 each) \$ \_\_\_\_\_  
 TOTAL enclosed \$ \_\_\_\_\_

**CLOSING DATE: 8 p.m. EST  
 WED. NOVEMBER 9, 2011**

Make fees payable to  
**Caledon Kennel Association** and mail to:  
 MJN Show Services  
 9 Samya Court  
 Scarborough, ON M1R 2A4

*Please type or print clearly*

Breed	Variety	Sex
-------	---------	-----

Enter in the following Classes:

- Junior Puppy       Bred by Exhibitor  
 Senior Puppy       Open  
 12 - 18 Month     Specials Only  
 Canadian Bred     Exhibition Only

Reg. Name of Dog \_\_\_\_\_

Check One – and – Enter Number here  <input type="checkbox"/> CKC Reg. No. <input type="checkbox"/> CKC ERN No. <input type="checkbox"/> CKC Misc. Cert. No. <input type="checkbox"/> Listed	Date of Birth D ____ M ____ Y ____	Is this a puppy? YES ___ NO ___
	Place of Birth <input type="checkbox"/> Canada <input type="checkbox"/> Elsewhere	

Breeder(s) \_\_\_\_\_

Sire \_\_\_\_\_

Dam \_\_\_\_\_

Reg'd Owner(s) \_\_\_\_\_

Owner's Address \_\_\_\_\_

City	Prov.	Code
------	-------	------

Name of Owner's Agent (if any)  
at the Show \_\_\_\_\_

Agent's Address \_\_\_\_\_

City	Prov.	Code
------	-------	------

Mail I.D. to  Owner or  Agent    Email \_\_\_\_\_

**FAX/CREDIT CARD ENTRIES**

Amer Express     Mastercard     VISA    Card No. \_\_\_\_\_    Expiry \_\_\_\_\_

Name of Cardholder \_\_\_\_\_    Signature \_\_\_\_\_

I CERTIFY that I am the registered owner(s) of the dog or that I am the authorized agent of the owner(s) whose name(s) I have entered above and accept full responsibility for all statements made in this entry. In consideration of the acceptance of this entry I (we) agree to be bound by the rules and regulations of the Canadian Kennel Club and by any additional rules and regulations appearing in the premium list. Also by signing this form, I certify that I will not hold the Show giving Club, its members, directors, employees or agents liable in the event of any accident of misfortune however caused.

SIGNATURE OF OWNER OR AGENT \_\_\_\_\_

TELEPHONE NO. \_\_\_\_\_

**ROYAL CANIN NATIONAL BREEDERS' CLASSIC**  
**SATURDAY NOVEMBER 26, 2011**

**OFFICIAL ENTRY FORM**  
**ENTRY: \$30.00 per Breeder's Team**

Entry Number
--------------

Please send entry form and cheque (payable to Caledon Kennel Association) to:  
 MJN Show Services  
 9 Samya Court, Scarborough ON M1R 2A4

*Entries must be received by 12 Noon (EST) Friday, November 25, 2011*

Breed/Variety		Breeder of Record		
<b>EXHIBIT 1</b>				
Name	Registration #/Country	Gender	Date of Birth (DD/MM/YY)	Breeder of Record
<b>EXHIBIT 2</b>				
Name	Registration #/Country	Gender	Date of Birth (DD/MM/YY)	Breeder of Record
<b>EXHIBIT 3</b>				
Name	Registration #/Country	Gender	Date of Birth (DD/MM/YY)	Breeder of Record
<b>EXHIBIT 4</b>				
Name	Registration #/Country	Gender	Date of Birth (DD/MM/YY)	Breeder of Record
<b>EXHIBIT 5</b>				
Name	Registration #/Country	Gender	Date of Birth (DD/MM/YY)	Breeder of Record

I hereby give permission for Royal Canin and/or their employees or agents to reduce, copy publish, broadcast or otherwise use my name, picture and/or video of me and/or my dog(s), likeness or statements or any material based or derived from them, in congratulatory advertising or promotional advertising for the Royal Canin National Breeders' Classic.

Breeder's Name \_\_\_\_\_ Breeder's Kennel Name \_\_\_\_\_

Breeder's Address/Phone \_\_\_\_\_

Breeder's Signature \_\_\_\_\_

Handler's Name & Signature \_\_\_\_\_

Handler's Name & Signature \_\_\_\_\_

Handler's Name & Signature \_\_\_\_\_

Handler's Name & Signature \_\_\_\_\_

Handler's Name & Signature \_\_\_\_\_





# ROYAL CANIN NATIONAL BREEDERS' CLASSIC SATURDAY NOVEMBER 26, 2011

Entries for this event will be accepted until 12 noon on Friday, November 25th, 2011  
(the day before the event).

### JUDGES

Damara Bolte of Leesburg, Virginia, Christine Hartz of Brookfield, Nova Scotia  
and Stefan Sinko of Lendava, Slovenia

### RULES

#### Breeder

1. Enters a minimum of 3 dogs to a maximum of 5 dogs – making up each Breeder's Team of the same breed.
2. Breeder must be the breeder of record on all dogs entered in the Team.
3. Canadian Kennel Club as well as foreign registered dogs are eligible.
4. Spayed or neutered dogs are eligible.
5. Exhibits must be over 6 months of age.
6. Entry fee \$30.00 per Breeder's Team.
7. Exhibits do not have to be entered in the regular Caledon Kennel Association shows.

#### Judging

1. The Royal Canin National Breeders' Classic will start no later than 6:00 pm on Saturday, November 26, 2011.
2. Breeder's Teams will be divided into two units (Group A and Group B) by a draw just prior to the start of judging.
3. Each unit will be judged by one of the Royal Canin's selected judges.
4. Four Finalists Teams will be selected from each unit to advance to the Finals to compete for Best in Classic and Reserve Best in Classic Awards.
5. Judges will judge the Breeder's Team as a unit to evaluate the overall quality of the breeding program as represented by the Team – its consistency of breed type and soundness.

#### Prizes – Awarded to the Breeder of Record

1. Best in Classic - \$2,500.00
2. Reserve Best in Classic - \$1,000.00
3. Finalists (8 awarded) - \$100.00

Rosettes – as above – donated by MJN Show Services

## WINE & CHEESE

Compliments of Dean Dennis Photography

There will be a Wine and Cheese reception on the show floor  
after Best in Show and before the Royal Canin National Breeders' Classic.

## CONFORMATION TROPHY LIST

Through the generosity of its members and friends, the Caledon Kennel Association is pleased to offer the following trophies. Note that all trophies must be picked up on the day they are awarded, none will be mailed. A complete list of trophy donors will appear in the show catalogue.

### "THE BEARS ARE BACK"

- Best in Show – Handmade Bear and Rosette
- Best Puppy in Show – Handmade Bear and Rosette
- 1<sup>st</sup> in each Group – Prize and Rosette
- Best Puppy in each Group – Prize and Rosette
- 2<sup>nd</sup> through 4<sup>th</sup> in each Group – Rosette

**Best in Show, Best Puppy in Show, all Group Firsts and  
all Best Puppy in Groups donated by Ren's Pet Foods**



The following people have donated to the **General Trophy Fund:**

Dannielle Adams & Brent Lane	Mary Capko
Diedre Devins	Patty Milton
Betty Olafson	Judi Orsi
Michael & Rosemary Shoreman	Carole Stubbs
Linda Woolley	

**Best Puppy In Show on Saturday, November 26, 2011** - Tiffany vase in memory of Gerona McCaig sponsored by French Bulldog breeders Dr. William Stoyka, Anne McIntyre & Pat Berry (Foxmoor & Petite Cherie Kennels).

**The San Marco Memorial Trophy** – in memory of Mr. Ray Fernandez donated by Eric Van Loo, Articligh Kennels. This is a perpetual trophy. The winner's name will be engraved and possession retained by C.K.A.

#### Breed Prizes:

- Toy Poodles all days  
– donated by Carole Stubbs
- West Highland White Terriers, Sunday November 27, 2011  
– donated by Bunny Petzlaff in memory of Salem
- Irish Wolfhounds, Saturday November 26, 2011  
– donated by Judith Orsi
- Border Terriers, Sunday, November 27, 2011  
– donated by Judith Orsi
- Border Terriers, Friday November 25, 2011  
– donated by Michael & Rosemary Shoreman
- Weimaraners, Saturday November 26, 2011  
– donated by Michael & Rosemary Shoreman

GREENERY Decor Compliments of Botanix Alliston

FLOWER ARRANGEMENTS for Royal Canin Booth and Dean Dennis Photography – Compliments of Suzanne Gardner Flowers



suzanne gardner  
FLOWERS

## BOOSTER SHOWS

The following clubs will support the entries and consider the classes for the Breed as their Booster.

### BARBET FANCIERS ASSOCIATION OF ONTARIO

Saturday, November 26, 2011 – Judge: Mr. S. Sinko

President	Paula Ballak	Vice President	Jocelyn Hart
Secretary	Ulla Pepper	Treasurer	Chantalle Joyce

Rosettes will be offered for each of the following: Best of Breed, Best of Opposite Sex, Best of Winners and Best Puppy in Breed.

### GERMAN SHORTHAIRED POINTER CLUB OF CANADA

Sunday, November 27, 2011 – Judge: Mr. C. Quinones

President	Maxine Moinier	Vice President	Tammy Parris
Secretary	Maria Foster	Treasurer	Barbara Taws

A trophy will be offered for: Best of Breed, Best of Opposite Sex, Best Puppy in Breed, Best of Winners, Winners Dog and Winners Bitch.

### RHODESIAN RIDGEBACK CLUB OF CANADA

Saturday, November 26, 2011 – Judge: Mrs. R. (Polly) Smith

President	Olive Taylor	Vice President	Karon Resch
Secretary	Jacque Dankner	Treasurer	Jacque Dankner

A trophy will be offered for: Best of Breed, Best of Opposite Sex, Best Puppy in Breed, Best of Winners, Winners Dog and Winners Bitch.

### ASSOCIATION OF RHODESIAN RIDGEBACK FANCIERS OF WESTERN ONTARIO

Sunday, November 27, 2011 – Judge: Dr. R. Smith

President	Stewart Dankner	Vice President	Malcolm Kennedy
Secretary	Jacque Dankner	Treasurer	Jacque Dankner

A trophy will be offered for: Best of Breed, Best of Opposite Sex, Best Puppy in Breed, Best of Winners, Winners Dog and Winners Bitch.

### D.O.B.E. ASSOCIATION

Saturday, November 26, 2011 – Judge: Mr. S. Sinko

President	Chris Cowie	Vice President	Larralyn McKay
Secretary	Pat Blenkey	Treasurer	Brian Casey

A trophy will be offered for: Best of Breed, Best of Opposite Sex, Best Puppy in Breed, Best of Winners, Winners Dog and Winners Bitch.

### LEONBERGER CLUB OF ONTARIO

Saturday, November 26, 2011 – Judge: Mr. S. Sinko

President	Gail Bishop	Vice President	Karen Heard
Sec/Treasurer	Glenna Stephens		

A trophy will be offered for: Best of Breed, Best of Opposite Sex, Best Puppy in Breed, Best of Winners, Winners Dog and Winners Bitch.

# TOP DOG DINNER

On Friday November 25<sup>th</sup> in conjunction with the Caledon KC Shows  
the Canadian Professional Handlers Association  
is hosting the 2011 Top Dog Dinner Awards and Benefit,  
this year benefitting "Friends in Need" and the "Sonny Tougas Bursary."

The Top Ten dogs of All Breeds for 2010 will be presented  
as well as the coveted Lifetime Achievement Award, Kishniga Award, Top  
Obedience Dog and Top Junior Handler (the Susan Hillman Award)

This year the dinner is at the beautiful Hockley Valley resort.  
Cocktails 6:00 p.m. Dinner and awards 7:00 p.m.



Tickets \$60.00

as well as sponsorships are available from:

Allison Foley for tickets at (902) 220-1632  
leadingedge@eastlink.ca

or

Judith Orsi at (905) 936-4744  
judi.orsi@gmail.com





**BREEDER OWNER  
HANDLER (BOH)  
COMPETITION**

This unofficial competition is open to all dogs owned and handled by the breeder during all regular class judging. The handler must be the owner/co-owner and breeder/co-breeder of the dog. All eligible dogs not directly or indirectly defeated by another eligible dog will compete for this award. The breeder/owner must handle the dog in its regular class, but in the case of having multiple eligible dogs, need not handle the dog for this competition.

**BOH CHALLENGE TROPHY:** Trophy to be retained by CCCO until permanent possession is obtained. For permanent possession, the trophy must be won three times by the same breeder, but not necessarily with the same dog or at consecutive shows.

**TROPHY FUND  
DONATIONS**

Please offer your support by making a donation to our trophy fund. All donors will be acknowledged in the official show catalogue and on the Chinese Crested Club of Ontario website/Facebook page.

Please visit [www.chinesecrestedontario.com](http://www.chinesecrestedontario.com) for more information on donating to our trophy fund.

You can also contact:

Kate Barnett  
1006-33 Davisville Ave, Toronto, ON M4S 1E8  
(647) 404-7310

or donate via PayPal to [info@chinesecrestedontario.com](mailto:info@chinesecrestedontario.com)

To be acknowledged in our catalogue, donations must be received by October 15th, 2011.



**CALEDON KENNEL ASSOCIATION  
LIMITED ENTRY OBEDIENCE TRIALS**

**Saturday, October 22, 2011 and Sunday, October 23, 2011**

held at **CAMPAIGN DOG ACADEMY**  
13417-22nd Side Road, R.R. 1, Georgetown ON

**JUDGES**

**October 22, 2011 - Cheryl Bishop and Paul Townshend**  
**October 23, 2011 - Susan Des Cotes and Leslie Marshall**

*For information, please contact*  
**Danuta Booth**

**1776 Woodview Avenue, Pickering ON L1V 1L5**  
**(905) 509-1951 [danutabooth@rogers.com](mailto:danutabooth@rogers.com)**



OFFICIAL CANADIAN KENNEL CLUB FORM  
**CONFORMATION**  
**CALEDON KENNEL ASSOCIATION**

- Friday, November 25, 2011
- Saturday, November 26, 2011
- Sunday, November 27, 2011

Entry Fees (\$30.00 per show) \$ \_\_\_\_\_  
Listing Fees (\$9.38 per show) \$ \_\_\_\_\_  
Exhibition Only (\$10.00 per show) \$ \_\_\_\_\_  
CATALOGUE (\$8.00 each) \$ \_\_\_\_\_  
TOTAL enclosed \$ \_\_\_\_\_

**CLOSING DATE: 8 p.m. EST**  
**WED. NOVEMBER 9, 2011**

Make fees payable to  
**Caledon Kennel Association** and mail to:  
MJN Show Services  
9 Samya Court  
Scarborough, ON M1R 2A4

*Please type or print clearly*

Breed	Variety	Sex
-------	---------	-----

Enter in the following Classes:

- Junior Puppy
- Senior Puppy
- 12 - 18 Month
- Canadian Bred
- Bred by Exhibitor
- Open
- Specials Only
- Exhibition Only

Reg. Name of Dog \_\_\_\_\_

Check One – and – Enter Number here <input type="checkbox"/> CKC Reg. No. <input type="checkbox"/> CKC ERN No. <input type="checkbox"/> CKC Misc. Cert. No. <input type="checkbox"/> Listed	Date of Birth D _____ M _____ Y _____	Is this a puppy? YES ___ NO ___
	Place of Birth <input type="checkbox"/> Canada <input type="checkbox"/> Elsewhere	

Breeder(s) \_\_\_\_\_

Sire \_\_\_\_\_

Dam \_\_\_\_\_

Reg'd Owner(s) \_\_\_\_\_

Owner's Address \_\_\_\_\_

City	Prov.	Code
------	-------	------

Name of Owner's Agent (if any) at the Show \_\_\_\_\_

Agent's Address \_\_\_\_\_

City	Prov.	Code
------	-------	------

Mail I.D. to  Owner or  Agent Email \_\_\_\_\_

**FAX/CREDIT CARD ENTRIES**

Amer Express  Mastercard  VISA Card No. \_\_\_\_\_ Expiry \_\_\_\_\_

Name of Cardholder \_\_\_\_\_ Signature \_\_\_\_\_

I CERTIFY that I am the registered owner(s) of the dog or that I am the authorized agent of the owner(s) whose name(s) I have entered above and accept full responsibility for all statements made in this entry. In consideration of the acceptance of this entry I (we) agree to be bound by the rules and regulations of the Canadian Kennel Club and by any additional rules and regulations appearing in the premium list. Also by signing this form, I certify that I will not hold the Show giving Club, its members, directors, employees or agents liable in the event of any accident of misfortune however caused.

SIGNATURE OF OWNER OR AGENT \_\_\_\_\_

TELEPHONE NO. \_\_\_\_\_

---

**BOOSTER SHOWS  
(cont'd)****LEONBERGER CLUB OF CANADA**

Sunday, November 27, 2011 – Judge: Mrs. R. (Polly) Smith

President	Heather Morrison	Vice President	Fran Cozens
Secretary	Kim Birch	Treasurer	Nancy Donald

A trophy will be offered for: Best of Breed, Best of Opposite Sex, Best Puppy in Breed, Best of Winners, Winners Dog and Winners Bitch.

**SAMOYED ASSOCIATION OF CANADA**

Sunday, November 27, 2011 – Judge: Mrs. R. (Polly) Smith

President	Dr. Robert Gaskin	Vice President	Suzanne Gardner
Secretary	Joann Dnistranksy	Treasurer	Lesley Deleo

**Dedication to Breeders****Helga and Frank Gruber – SHEBASKA Samoyeds**

Cash prizes will be offered divided equally between the Owner/s and Breeder/s only of the following: Best of Breed (\$100), Best of Opposite Sex (\$50), Best of Winners (\$25) and Best Puppy in Breeder (\$25). Rosettes will be offered for each of the following: Best of Breed, Best of Opposite Sex, Best of Winners, Best Puppy in Breed, Winners Dog and Winners Bitch.

*This is the 45th Anniversary of the Samoyed Association of Canada and to Honour Helga and Frank Gruber, we will be having a cake cutting ceremony after Best of Breed on Sunday.*

**THE STANDARD SCHNAUZER CLUB OF CANADA**

Saturday, November 26, 2011 – Judge: Mr. S. Sinko

President	Line Champagne	Vice President	Heather Pedersen
Secretary	Beth Lawrence	Treasurer	Ron Lawrence

A trophy will be offered for: Best of Breed, Best of Opposite Sex, Best Puppy in Breed, Winners Dog and Winners Bitch.

**KERRY BLUE TERRIER CLUB OF CANADA**

Saturday, November 26, 2011 – Judge: Mr. R. Black

President	France Godbout	Vice President	Barb Thompson
Secretary	Louise Lang	Treasurer	Linda Lee

A trophy will be offered for: Best of Breed, Best of Opposite Sex, Best Puppy in Breed, Best of Winners, Winners Dog and Winners Bitch.

**THE NORFOLK TERRIER CLUB OF CANADA**

Friday, November 25, 2011 – Judge: Mrs. R. (Polly) Smith

Sunday, November 27, 2011 – Judge: Dr. R. Smith

President	Linda Dowdle	Vice President	Lee Goodfellow
Secretary	Sarah Paquette	Treasurer	Susan Chronowic

A trophy will be offered for: Best of Breed, Best of Opposite Sex, Best Puppy in Breed, Best of Winners, Winners Dog and Winners Bitch.



---

**CHINESE  
CRESTED CLUB  
OF ONTARIO  
OFFICERS**

**President**  
Nancy Patterson  
**Vice-President**  
Julie Milton

**Secretary/Treasurer**  
Kate Barnett  
**Website**  
www.chinesecrestedontario.com

---

**SHOW  
COMMITTEE**

**Show Chairpersons**  
Kate Barnett & Nancy Patterson  
**Show Superintendent & Secretary**  
MJN Show Services (416) 759-8593  
9 Samya Court  
Scarborough, ON M1R 2A4  
www.mjnshowservices.com

---

**JUDGES &  
ASSIGNMENTS**

**Donald B.G. Duncan**  
86 Bow Valley Drive, Scarborough ON M1G 3J6

*All Official Classes, Open (divided into Hairless and Powderpuff), Veterans (7 to 9 yrs, 9 yrs +), Award of Merit, Stud Dog, Brood Bitch and Brace*

---

**ENTRY FEES  
SPECIALTY  
SHOW**

Entry fee per dog, per class ..... \$30.00  
Listing Fee per dog ..... \$9.38  
Exhibition Only ..... \$10.00  
Stud Dog, Brood Bitch, Brace (each) ..... \$15.00

**All fees include H.S.T. and are in Canadian Funds.** A listing fee is payable for all dogs entered at shows who do not have an individual C.K.C. registration number, or an E.R.N.No. All cheques and money orders are to be made payable to **Caledon Kennel Association** and mailed to:

MJN Show Services  
9 Samya Court  
Scarborough, ON M1R 2A4

**Entries close 8:00 p.m. (EST) Wednesday, November 9, 2011.**

**All Rules and Regulations pertaining to the All-Breed Show are applicable to this Specialty Show.**

---

**SPECIALTY  
TROPHY LIST**

Through the generosity of members and friends, the Chinese Crested Club of Ontario will offer rosettes, certificates and prizes for Best of Breed, Best of Opposite Sex, Best of Winners, Winners Dog, Winners Bitch, Best Puppy, Best Veteran, Best Stud Dog, Best Brood Bitch, and Best Brace. Ribbons and prizes will be offered for first through fourth in each class.

Award of Merit: One Award (with rosette, certificate and prize) will be presented at the discretion of the judge for every ten dogs competing at Best of Breed level.



OFFICIAL CANADIAN KENNEL CLUB FORM  
**CHINESE CRESTED CLUB OF ONTARIO  
 SPECIALTY**

**Saturday, November 26, 2011**

- Official Classes  \$30.00
- Listing Fee  9.38
- Exhibition Only  10.00
- Stud Dog/Brood Bitch  15.00
- Brace  15.00

**CLOSING DATE: 8 p.m. EST  
 WED. NOVEMBER 9, 2011**  
 Make fees payable to  
**Caledon Kennel Association**  
 and mail to:  
 MJN Show Services  
 9 Samya Court  
 Scarborough, ON M1R 2A4

TOTAL \$ \_\_\_\_\_ *Please mark all classes clearly*

Breed <b>CHINESE CRESTED</b>	Variety	Sex
------------------------------	---------	-----

Enter in the following Classes:

- Junior Puppy
- Senior Puppy
- 12-18 Months
- Canadian Breed
- Bred by Exhibitor
- Open - Hairless
- Open - Powderpuff
- Veterans
- class  7-9 yrs.  9+ yrs
- Specials Only
- Stud Dog
- Brood Bitch
- Brace
- Best Breeder/Owner/Handler
- Exhibition Only

Reg. Name of Dog

Check One – and – Enter Number here	Date of Birth	Is this a puppy?
<input type="checkbox"/> CKC Reg. No.	D _____ M _____ Y _____	YES ___ NO ___
<input type="checkbox"/> CKC ERN No.	Place of Birth	
<input type="checkbox"/> CKC Misc. Cert. No.		
<input type="checkbox"/> Listed		

Breeder(s) \_\_\_\_\_

Sire \_\_\_\_\_

Dam \_\_\_\_\_

Reg'd Owner(s) \_\_\_\_\_

Owner's Address \_\_\_\_\_

City	Prov.	Code
------	-------	------

Name of Owner's Agent (if any)  
 at the Show \_\_\_\_\_

Agent's Address \_\_\_\_\_

City	Prov.	Code
------	-------	------

Mail I.D. to  Owner or  Agent Email \_\_\_\_\_

<b>FAX/CREDIT CARD ENTRIES</b>	
<input type="checkbox"/> Amer Express <input type="checkbox"/> Mastercard <input type="checkbox"/> VISA	Card No. _____ Expiry _____
Name of Cardholder _____	Signature _____

I CERTIFY that I am the registered owner(s) of the dog or that I am the authorized agent of the owner(s) whose name(s) I have entered above and accept full responsibility for all statements made in this entry. In consideration of the acceptance of this entry I (we) agree to be bound by the rules and regulations of the Canadian Kennel Club and by any additional rules and regulations appearing in the premium list. Also by signing this form, I certify that I will not hold the Show giving Club, its members, directors, employees or agents liable in the event of any accident of misfortune however caused.

\_\_\_\_\_  
 SIGNATURE OF OWNER OR AGENT

\_\_\_\_\_  
 TELEPHONE NO.

**BOOSTER SHOWS  
 (cont'd)**

**ASSOCIATION OF PARSON RUSSELL TERRIER FANCIERS**

Saturday, November 26, 2011 – Judge: Mr. R. Black

President Gail Caudle Vice President Joan Tuckey  
 Secretary Addison White Treasurer Susan Crawford

A trophy will be offered for: Best of Breed, Best of Opposite Sex, Best Puppy in Breed, Winners Dog and Winners Bitch.

**THE CANADIAN WEST HIGHLAND WHITE TERRIER CLUB**

Saturday, November 26, 2011 – Judge: Mr. R. Black

President Kelly Greir 1st Vice President Carole Thornton  
 Secretary Alison Mitchell Treasurer Kevin Chan

A trophy will be offered for: Best of Breed, Best of Opposite Sex, Best Puppy in Breed, Winners Dog and Winners Bitch.

**EASTERN CANADA FRENCH BULLDOG CLUB**

Saturday, November 26, 2011 – Judge: Dr. R. Smith

President Carole Gravestock Vice President Paula Roberts  
 Sec/Treasurer Sean Fredericks

Rosettes will be offered for each of the following: Best of Breed, Best of Opposite Sex, Best of Winners, Best Puppy in Breed, Winners Dog, Winners Bitch and Each Class Winner. A trophy will be offered for each of the following: Best of Breed and Best of Opposite Sex with gifts for each Class Winner.

**LHASA APSO CANADA**

Saturday, November 26, 2011 – Judge: Dr. R. Smith

President Arlene Miller Vice President Ted Fahlgren  
 Secretary Gayle Gerard Treasurer Anne Swantee

A trophy will be offered for: Best of Breed, Best of Opposite Sex, Best Puppy in Breed, Best of Winners, Winners Dog, Winners Bitch, Reserve Winners Dog and Reserve Winners Bitch.

**LHASA APSO CLUB OF ONTARIO**

Sunday, November 27, 2011 – Judge: Mr. S. Sinko

President Anne Swantee Vice President Elaine Brown  
 Secretary Ted Fahlgren Treasurer Sharon Quan

A trophy will be offered for: Best of Breed, Best of Opposite Sex, Best Puppy in Breed, Best of Winners, Winners Dog, Winners Bitch, Reserve Winners Dog and Reserve Winners Bitch.

**DOMINION COLLIE & SHETLAND SHEEPDOG ASSOCIATION**

Sunday, November 27, 2011 – Judge: Dr. R. Smith

President Glen Stark Vice President Amanda McLeod  
 Secretary Cheryl Pike Treasurer Irene Latchford

A trophy will be offered for: Best of Breed, Best of Opposite Sex, Best Puppy in Breed, Best of Winners, Winners Dog and Winners Bitch.

## JUNIOR HANDLING EVENTS

### JUNIOR HANDLING INVITATIONAL (UNOFFICIAL)

#### BEST JUNIOR HANDLER OF THE CALEDON KENNEL ASSOCIATION SHOW

No entry is required as this is an unofficial invitational competition. All first place winners, at each competitive level, from each of the two days of Juniors, will be invited to compete in this event. There will be no Ribbons or Rosettes presented at this level. The six winners will advance to the final judging, where a single award will be given.

**BEST OVERALL - \$200.00 VISA GIFT CARD**  
Donated by Royal Canin



The five remaining Junior Handlers will receive a \$50.00 VISA GIFT CARD

### JUNIOR HANDLING

**Saturday, November 26 and Sunday November 27**

*All Best Overall Junior Handler judging will be done prior to Best in Show on Saturday and Sunday.*

Held under CKC Rules - Judges to be announced day of show.

#### CLASSES:

Pee Wee 4 – 6 yrs. (non-competitive)  
Junior 7 – 10 yrs. (Novice and Open)  
Intermediate 11 – 14 yrs. (Novice and Open)  
Senior 15 – up to but not incl. 18 yrs. (Novice and Open)  
Best Overall (excluding Pee Wee)

*All dogs for Junior Handling must be entered in one of the Official Classes or Exhibition Only on the day of competition. Entry to be made at the show. Complete rules will appear in the Show Catalogue. Age for all classes is December 31st of the preceeding year.*

**Saturday, November 26th** – supported by Best in Show Dog Supplies with 1<sup>st</sup> in each class and Best Overall Junior Handler gift certificates.



**Sunday, November 27<sup>th</sup>** – supported by Royal Canin with 1<sup>st</sup> in each class and Best Overall Junior Handler prizes.



Ribbons and Rosettes donated by MJN Show Services.

### JUNIOR HANDLING TRAINING

**Thursday Evening, November 24, 2011 – 6:30 p.m.**

There will be Junior Handling training, compliments of The Canadian Professional Handlers Association, held on Thursday evening, at 6:30 p.m. Just come along with your dog to the show site and learn from the Pros.



### CYTA SPECIALTY TROPHY LIST

Through the generosity of members and friends, The Canadian Yorkshire Terrier Association Inc. will offer a Rosette and a Prize for the following awards:

Best Of Breed	Best Of Opposite Sex
Best Puppy In Breed	Best Of Winners
Winners Dog	Winners Bitch

Rosettes are also offered for:  
Best in Sweepstakes and Best of Opposite Sex in Sweepstakes.

Flat ribbons will be awarded for 1st through 4th placements in all Regular classes and Sweepstakes classes.

Award of Merit: At the judge's discretion, Award of Merit Rosettes may be awarded up to one Award for every ten dogs compete for Best of Breed, which will be presented following Best of Breed judging.

All donors to the trophy fund will be acknowledged in the official Show Catalogue.

The following classes are offered:

Junior (6-9 mos.)  
Senior (9-12 mos.)  
Open (12-18 mos.) on the day of the Specialty.  
**Classes are divided by sex.**

First Place winners of each class (6 winners) will compete for Best in Sweepstakes and Best of Opposite Sex in Sweepstakes.

**PRIZE MONEY** – Money received in entry fees shall be divided as follows:  
25% of total fees will be retained by the club for administration.  
Best in Sweepstakes will receive 25% of total entry fee  
Best of Opposite Sex in Sweepstakes will receive 20% of total entry fee  
First Place winners in each class will divide the remaining 30% of the total entry fee

**Dogs entered in Sweepstakes must be entered in one of the Official Classes at this Specialty.**

### CYTA SPECIALTY SWEEPSTAKES

### NON-MEMBER PARTICIPATION FEE



Effective January 1, 2011:

- A non-member participation fee will be charged to a resident of Canada who is a non-member of the CKC. The fee will be \$57.60 plus applicable taxes.
- The non-member participation fee is paid in any year a title is earned and covers all titles and dogs owned by that individual.
- In order for the title to be awarded, the non-member will have a choice to either become a CKC member or pay the non-member participation fee. Failure to comply within 30 days of notification will result in the title being withheld and the dog cannot be moved up to the next level.
- The fee applies only to dogs wholly owned by non-member residents of Canada and is not applicable to CKC members.





OFFICIAL CANADIAN KENNEL CLUB FORM  
**CANADIAN YORKSHIRE TERRIER  
 ASSOCIATION INC.**

**Saturday, November 26, 2011**

**CLOSING DATE: 8 p.m. EST  
 WED. NOVEMBER 9, 2011**  
 Make fees payable to  
**Caledon Kennel Association**  
 and mail to:  
 MJN Show Services  
 9 Samya Court  
 Scarborough, ON M1R 2A4

- Official Classes  \$30.00  
 Listing Fee  9.38  
 Exhibition Only  10.00  
 Sweepstakes  15.00

TOTAL \$ \_\_\_\_\_ *Please mark all classes clearly*

Breed <b>YORKSHIRE TERRIER</b>	Variety	Sex
--------------------------------	---------	-----

Enter in the following Classes:

- Junior Puppy  Open  Sweepstakes (class) \_\_\_\_\_  
 Senior Puppy  Veterans  
 12-18 Months  Specials Only  
 Canadian Bred  Exhibition Only  
 Bred by Exhibitor

Reg. Name of Dog

Check One – and – Enter Number here  <input type="checkbox"/> CKC Reg. No. <input type="checkbox"/> CKC ERN No. <input type="checkbox"/> CKC Misc. Cert. No. <input type="checkbox"/> Listed	Date of Birth D ____ M ____ Y ____	Is this a puppy? YES ___ NO ___
	Place of Birth <input type="checkbox"/> Canada <input type="checkbox"/> Elsewhere	

Breeder(s) \_\_\_\_\_

Sire \_\_\_\_\_

Dam \_\_\_\_\_

Reg'd Owner(s) \_\_\_\_\_

Owner's Address \_\_\_\_\_

City	Prov.	Code
------	-------	------

Name of Owner's Agent (if any)  
at the Show

Agent's Address \_\_\_\_\_

City	Prov.	Code
------	-------	------

Mail I.D. to  Owner or  Agent Email \_\_\_\_\_

<b>FAX/CREDIT CARD ENTRIES</b>	
<input type="checkbox"/> Amer Express <input type="checkbox"/> Mastercard <input type="checkbox"/> VISA Card No. _____	Expiry _____
Name of Cardholder _____	Signature _____

I CERTIFY that I am the registered owner(s) of the dog or that I am the authorized agent of the owner(s) whose name(s) I have entered above and accept full responsibility for all statements made in this entry. In consideration of the acceptance of this entry I (we) agree to be bound by the rules and regulations of the Canadian Kennel Club and by any additional rules and regulations appearing in the premium list. Also by signing this form, I certify that I will not hold the Show giving Club, its members, directors, employees or agents liable in the event of any accident of misfortune however caused.

SIGNATURE OF OWNER OR AGENT

TELEPHONE NO.



**REGIONAL SPECIALTY SHOW  
 GERMAN SHORTHAIRED POINTER  
 CLUB OF CANADA  
 Saturday, November 26, 2011**

**GERMAN  
 SHORTHAIRED  
 POINTER CLUB  
 OF CANADA  
 OFFICERS**

- |                         |                     |
|-------------------------|---------------------|
| <i>President</i>        | Mazine Moinier      |
| <i>Vice President</i>   | Tammy Parris        |
| <i>Secretary</i>        | Maria Foster        |
| <i>Treasurer</i>        | Barbara Taws        |
| <i>Ontario Director</i> | Nancibeth Koutstaal |

**SHOW  
 COMMITTEE**

*Show Chairperson*  
 Maria Foster  
 aspenglow@sympatico.ca  
*Show Superintendent & Secretary*  
 MJN Show Services (416) 759-8593  
 9 Samya Court  
 Scarborough, ON M1R 2A4  
 www.mjnshowservices.com

**JUDGES &  
 ASSIGNMENTS**

**Dr. Robert Smith**  
 P.O.Box 309, St. Stephans Church, VA 23148-0309 U.S.A.

*All Official Classes, Veterans, Award of Merit, Field Dog and Bitch, Stud Dog and Brood Bitch*

**Ms. Janice Wolff**  
 98 Greenfield Road, Brantford, ON N3R 6Z7

*Sweepstakes*

**ENTRY FEES  
 SPECIALTY  
 SHOW**

Entry fee per dog, per class ..... \$30.00  
 Listing Fee per dog ..... \$9.38  
 Exhibition Only ..... \$10.00  
 Unofficial Classes ..... \$15.00  
 Sweepstakes ..... \$15.00  
 Stud Dog and get/Brood Bitch and progeny (each) ..... \$15.00

**All fees include H.S.T. and are in Canadian Funds.** A listing fee is payable for all dogs entered at shows who do not have an individual C.K.C. registration number, or an E.R.N. No. All cheques and money orders are to be made payable to **Caledon Kennel Association** and mailed to:  
 MJN Show Services  
 9 Samya Court  
 Scarborough, ON M1R 2A4

**Entries close 8:00 p.m. (EST) Wednesday, November 9, 2011.**

*All Rules and Regulations pertaining to the All-Breed Show are applicable to this Specialty Show.*



OFFICIAL CANADIAN KENNEL CLUB FORM  
**GERMAN SHORTHAIRED POINTER  
 CLUB OF CANADA**

**Saturday, November 26, 2011**

- Official Classes  \$30.00
- Listing Fee  9.38
- Exhibition Only  10.00
- Sweepstakes  15.00
- Stud Dog/Brood Bitch (ea)  15.00
- Unofficial Class  15.00

**CLOSING DATE: 8 p.m. EST  
 WED. NOVEMBER 9, 2011**  
 Make fees payable to  
**Caledon Kennel Association**  
 and mail to:  
 MJN Show Services  
 9 Samya Court  
 Scarborough, ON M1R 2A4

TOTAL \$\_\_\_\_\_ *Please mark all classes clearly*

Breed <b>GERMAN SHORTHAIRED POINTER</b>	Variety	Sex
---	---------	-----

Enter in the following Classes:

- Junior Puppy
- Senior Puppy
- 12-18 Months
- Canadian Bred
- Bred by Exhibitor
- Open
- Veterans
- Specials Only
- Exhibition Only
- Field Dog Class
- Stud Dog
- Brood Bitch
- Sweepstakes (class) \_\_\_\_\_

Reg. Name of Dog

Check One – and – Enter Number here	Date of Birth	Is this a puppy?
<input type="checkbox"/> CKC Reg. No.	D _____ M _____ Y _____	YES ___ NO ___
<input type="checkbox"/> CKC ERN No.	Place of Birth	<input type="checkbox"/> Canada <input type="checkbox"/> Elsewhere
<input type="checkbox"/> CKC Misc. Cert. No.		
<input type="checkbox"/> Listed		

Breeder(s) \_\_\_\_\_

Sire \_\_\_\_\_

Dam \_\_\_\_\_

Reg'd Owner(s) \_\_\_\_\_

Owner's Address \_\_\_\_\_

City	Prov.	Code
------	-------	------

Name of Owner's Agent (if any)

at the Show

Agent's Address \_\_\_\_\_

City	Prov.	Code
------	-------	------

Mail I.D. to  Owner or  Agent Email \_\_\_\_\_

**FAX/CREDIT CARD ENTRIES**

Amer Express  Mastercard  VISA Card No. \_\_\_\_\_ Expiry \_\_\_\_\_

Name of Cardholder \_\_\_\_\_ Signature \_\_\_\_\_

I CERTIFY that I am the registered owner(s) of the dog or that I am the authorized agent of the owner(s) whose name(s) I have entered above and accept full responsibility for all statements made in this entry. In consideration of the acceptance of this entry I (we) agree to be bound by the rules and regulations of the Canadian Kennel Club and by any additional rules and regulations appearing in the premium list. Also by signing this form, I certify that I will not hold the Show giving Club, its members, directors, employees or agents liable in the event of any accident of misfortune however caused.

SIGNATURE OF OWNER OR AGENT

TELEPHONE NO.



**NATIONAL SPECIALTY SHOW  
 THE CANADIAN YORKSHIRE TERRIER  
 ASSOCIATION INC.**

**Saturday, November 26, 2011**

**NORFOLK  
 TERRIER CLUB  
 OF CANADA  
 OFFICERS**

*President*  
 Theresa Franz  
*Vice-President*  
 Myrtle Elms  
*Treasurer*  
 Loreta Serafini

*Secretary*  
 Carol Proctor  
*Directors*  
 Kim Skiba, Western Canada  
 Eric Franz, Ontario  
 Vicky Hamilton, Ontario  
 Dwain Mclean, Eastern Canada

**SHOW  
 COMMITTEE**

*Show Chairperson*  
 Lilly DeWitte  
 dewitte\_simon@hotmail.com  
*Show Superintendent & Secretary*  
 MJN Show Services (416) 759-8593  
 9 Samya Court  
 Scarborough, ON M1R 2A4  
 www.mjnshowservices.com

**JUDGES &  
 ASSIGNMENTS**

**Carlos Quinones**  
 Calle 123 No.60-23, Bogata, Colombia

*All Official Classes, Veterans and Award of Merit*

**Myrtle Elms**  
 149 Saint Lucie Drive, Weston, ON, M9M 1T4

*Sweepstakes*

**ENTRY FEES  
 SPECIALTY  
 SHOW**

Entry fee per dog, per class ..... \$30.00  
 Listing Fee per dog ..... \$9.38  
 Exhibition Only ..... \$10.00  
 Sweepstakes ..... \$15.00

**All fees include H.S.T. and are in Canadian Funds.** A listing fee is payable for all dogs entered at shows who do not have an individual C.K.C. registration number, or an E.R.N.No. All cheques and money orders are to be made payable to **Caledon Kennel Association** and mailed to:

MJN Show Services  
 9 Samya Court  
 Scarborough, ON M1R 2A4

**Entries close 8:00 p.m. (EST) Wednesday, November 9, 2011.**

**All Rules and Regulations pertaining to the All-Breed Show are applicable to this Specialty Show.**



OFFICIAL CANADIAN KENNEL CLUB FORM  
**NORFOLK TERRIER CLUB OF CANADA**  
 Saturday, November 26, 2011

Official Classes  \$30.00  
 Listing Fee  9.38  
 Exhibition Only  10.00  
 Sweepstakes  15.00  
 Stud Dog/Brood Bitch (ea)  15.00

**CLOSING DATE: 8 p.m. EST**  
**WED. NOVEMBER 9, 2011**  
 Make fees payable to  
**Caledon Kennel Association**  
 and mail to:  
 MJN Show Services  
 9 Samya Court  
 Scarborough, ON M1R 2A4

TOTAL \$ \_\_\_\_\_

*Please mark all classes clearly*

Breed <b>NORFOLK TERRIER</b>	Variety	Sex
------------------------------	---------	-----

Enter in the following Classes:

- Junior Puppy     Open     Stud Dog  
 Senior Puppy     Veterans     Brood Bitch  
 12-18 Months     Specials Only     Sweepstakes (class) \_\_\_\_\_  
 Canadian Bred     Exhibition Only  
 Bred by Exhibitor

Reg. Name of Dog \_\_\_\_\_

Check One – and – Enter Number here  <input type="checkbox"/> CKC Reg. No. <input type="checkbox"/> CKC ERN No. <input type="checkbox"/> CKC Misc. Cert. No. <input type="checkbox"/> Listed	Date of Birth D ____ M ____ Y ____	Is this a puppy? YES ___ NO ___
	Place of Birth <input type="checkbox"/> Canada <input type="checkbox"/> Elsewhere	

Breeder(s) \_\_\_\_\_

Sire \_\_\_\_\_

Dam \_\_\_\_\_

Reg'd Owner(s) \_\_\_\_\_

Owner's Address \_\_\_\_\_

City _____	Prov. _____	Code _____
------------	-------------	------------

Name of Owner's Agent (if any)  
at the Show \_\_\_\_\_

Agent's Address \_\_\_\_\_

City _____	Prov. _____	Code _____
------------	-------------	------------

Mail I.D. to  Owner or  Agent    Email \_\_\_\_\_

**FAX/CREDIT CARD ENTRIES**

Amer Express     Mastercard     VISA    Card No. \_\_\_\_\_    Expiry \_\_\_\_\_

Name of Cardholder \_\_\_\_\_    Signature \_\_\_\_\_

I CERTIFY that I am the registered owner(s) of the dog or that I am the authorized agent of the owner(s) whose name(s) I have entered above and accept full responsibility for all statements made in this entry. In consideration of the acceptance of this entry I (we) agree to be bound by the rules and regulations of the Canadian Kennel Club and by any additional rules and regulations appearing in the premium list. Also by signing this form, I certify that I will not hold the Show giving Club, its members, directors, employees or agents liable in the event of any accident of misfortune however caused.

\_\_\_\_\_  
SIGNATURE OF OWNER OR AGENT

\_\_\_\_\_  
TELEPHONE NO.

**GSP CLUB  
OF CANADA  
SPECIALTY  
TROPHY LIST**

Through the generosity of members and friends, the German Shorthaired Pointer Club of Canada will offer a Rosette and a Prize for the following awards:

Best Of Breed	Best Of Opposite Sex
Best Puppy In Breed	Best Of Winners
Winners Dog	Winners Bitch
Veteran Dog	Veteran Bitch
Best Veteran	
Best Stud Dog	Best Brood Bitch
Best Field Dog	Best Field Bitch

Rosettes are also offered for:

Reserve Winners Dog, Reserve Winners Bitch, Best in Sweepstakes, Best of Opposite Sex in Sweepstakes and all class placements in sweepstakes.

Flat ribbons will be awarded for 1st through 4th placements in all Regular classes.

Award of Merit: At the judge's discretion, Award of Merit Rosettes may be awarded up to one Award for every ten dogs compete for Best of Breed, which will be presented following Best of Breed judging.

**GSP CLUB  
OF CANADA  
SPECIALTY  
SWEEPSTAKES**

The following classes are offered:

Junior (6-9 mos.)  
 Senior (9-12 mos.)  
 Open (12-18 mos.) on the day of the Specialty.  
**Classes are divided by sex.**

First Place winners of each class (6 winners) will compete for Best in Sweepstakes and Best of Opposite Sex in Sweepstakes.

**PRIZE MONEY** – Money received in entry fees shall be divided as follows:  
 25% of total fees will be retained by the club for administration.  
 Best in Sweepstakes will receive 25% of total entry fee  
 Best of Opposite Sex in Sweepstakes will receive 20% of total entry fee  
 First Place winners in each class will divide the remaining 30% of the total entry fee

**Dogs entered in Sweepstakes must be entered in one of the Official Classes at this Specialty.**

**EVENT  
REGISTRATION  
NUMBER (ERN)**

Effective Jan. 1/92, all dogs that are foreign born and foreign owned and enter Canada for the sole purpose of entering CKC events will no longer require a CKC registration number but will require an Event Registration Number (ERN). The ERN number MUST be applied for within 30 days of the first day of entering a CKC event. Fee is \$57.60 per dog after January 1, 2011 plus applicable taxes. For further information contact:

The Canadian Kennel Club  
 Phone: (416) 675-5511  
 Fax: (416) 675-6506  
 information@ckc.ca  
 Hours: 9:00 a.m. - 5:00 p.m. (Monday - Friday)



NATIONAL SPECIALTY SHOW  
**NORFOLK TERRIER CLUB OF CANADA**  
 Saturday, November 26, 2011

**NORFOLK  
 TERRIER CLUB  
 OF CANADA  
 OFFICERS**

*President* Linda Dowdle  
*Vice President* Lee Goodfellow  
*Secretary* Sarah Paquette  
*Treasurer* Susan Chronowic  
  
*Website* www.norfolkterrierclubofcanada.ca

**SHOW  
 COMMITTEE**

*Show Chairperson*  
 Judy White  
*Show Superintendent & Secretary*  
 MJN Show Services (416) 759-8593  
 9 Samya Court  
 Scarborough, ON M1R 2A4  
 www.mjnshowservices.com

**JUDGES &  
 ASSIGNMENTS**

**Mr. Stefan Sinko**  
 Glavna ul.47, Lendava, Slovenia 9220

*All Official Classes, Veterans, Award of Merit, Stud Dog and Brood Bitch*

**Mr. Robert Wilson**  
 20 Forest Hill Drive, R.R.#3, Everett, ON L0M 1J0

*Sweepstakes and Junior Handling*

**ENTRY FEES  
 SPECIALTY  
 SHOW**

Entry fee per dog, per class ..... \$30.00  
 Listing Fee per dog ..... \$9.38  
 Exhibition Only ..... \$10.00  
 Unofficial Classes ..... \$15.00  
 Sweepstakes ..... \$15.00  
 Stud Dog and get/Brood Bitch and progeny (each) ..... \$15.00

**All fees include H.S.T. and are in Canadian Funds.** A listing fee is payable for all dogs entered at shows who do not have an individual C.K.C. registration number, or an E.R.N. No. All cheques and money orders are to be made payable to **Caledon Kennel Association** and mailed to:  
 MJN Show Services  
 9 Samya Court  
 Scarborough, ON M1R 2A4

**Entries close 8:00 p.m. (EST) Wednesday, November 9, 2011.**

**All Rules and Regulations pertaining to the All-Breed Show are applicable to this Specialty Show.**

**NORFOLK  
 TERRIER CLUB  
 OF CANADA  
 SPECIALTY  
 TROPHY LIST**

Through the generosity of friends and members, the Norfolk Terrier Club of Canada will offer a Rosette and a Prize for the following awards:

Best Of Breed	Best Of Opposite Sex
Best Puppy In Breed	Best Of Winners
Winners Dog	Winners Bitch
Veteran Dog	Veteran Bitch
Best Veteran	Best Canadian Bred
Best Stud Dog	Best Brood Bitch

Rosettes are also offered for:  
 Best in Sweepstakes and Best of Opposite Sex in Sweepstakes.

Flat ribbons will be awarded for 1st through 4th placements in all Regular classes and Sweepstakes classes.

Award of Merit: At the judge's discretion, Award of Merit Rosettes may be awarded up to one Award for every ten dogs compete for Best of Breed, which will be presented following Best of Breed judging.

**NORFOLK  
 TERRIER CLUB  
 OF CANADA  
 SPECIALTY  
 SWEEPSTAKES**

The following classes are offered:  
 Junior (6-9 mos.)  
 Senior (9-12 mos.)  
 Open (12-18 mos.) on the day of the Specialty.  
**Classes are divided by sex.**

First Place winners of each class (6 winners) will compete for Best in Sweepstakes and Best of Opposite Sex in Sweepstakes.

**PRIZE MONEY** – Money received in entry fees shall be divided as follows:  
 25% of total fees will be retained by the club for administration.  
 Best in Sweepstakes will receive 25% of total entry fee  
 Best of Opposite Sex in Sweepstakes will receive 20% of total entry fee  
 First Place winners in each class will divide the remaining 30% of the total entry fee

**Dogs entered in Sweepstakes must be entered in one of the Official Classes at this Specialty.**

**NORFOLK  
 TERRIER CLUB  
 OF CANADA  
 SPECIALTY  
 JUNIOR  
 HANDLING**

Held under CKC Rules, for Norfolk Terriers only, following the specialty.  
 Judge - Mr. Robert Wilson

Pee Wee	4 – 6 yrs. (non-competitive)
Junior	7 – 10 yrs. (Novice and Open)
Intermediate	11 – 14 yrs. (Novice and Open)
Senior	15 – up to but not incl. 18 yrs. (Novice and Open)
Best Overall	(excluding Pee Wee)

*All Norfolk Terrier dogs for Junior Handling must be entered in one of the Specialty's Official Classes or Exhibition Only on the day of competition.*

Entry to be made at the show. Complete rules will appear in the Show Catalogue. Age for all classes is December 31st of the preceeding year.

Ribbons and Rosettes donated by MJN Show Services.